

Alamo Lake

All Controls

Saturday, April 20, 2024

©2024 - Greater Phoenix Orienteering Club
 Contour Interval: 10 meters from NAIP Point Cloud
 Vegetation: NDVI from 1m NAIP Images
gphxo.org

Paper Size: Tabloid, Landscape (17"x11")
 Note: The numeric scale information is correct only if printing or copying at the paper size listed above with no print scaling. The scale bar is correct at any size.

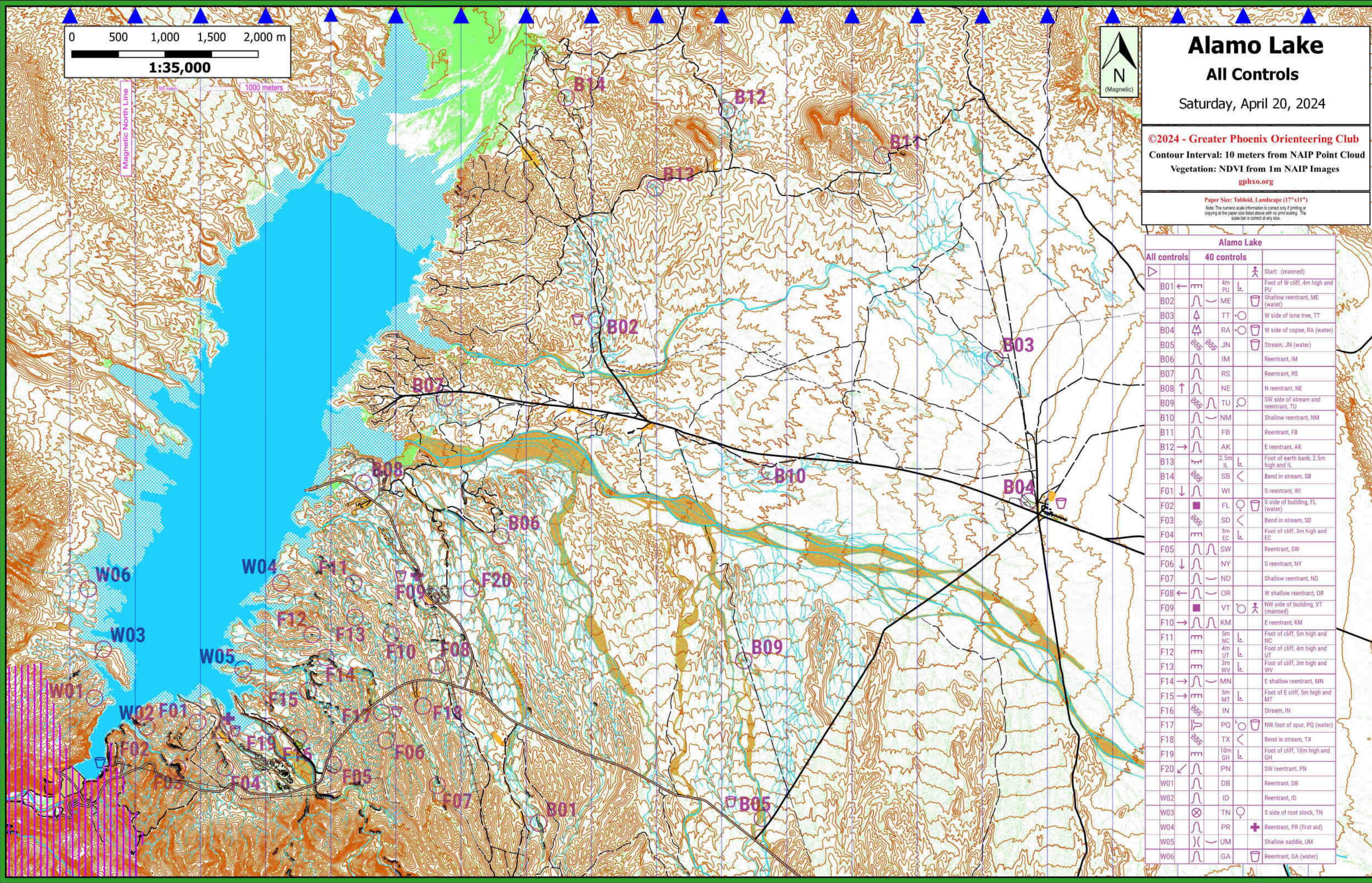

Alamo Lake				
All controls		40 controls		
△				Start: (manned)
B01	←	4m PU	⌋	Foot of W cliff, 4m high and PU
B02	∩	ME	∩	Shallow reentrant, ME (water)
B03	△	TT	○	W side of lone tree, TT
B04	⌋	RA	∩	W side of copse, RA (water)
B05	∩	JN	∩	Stream, JN (water)
B06	∩	IM		Reentrant, IM
B07	∩	RS		Reentrant, RS
B08	↑	NE		N reentrant, NE
B09	∩	TU	○	SW side of stream and reentrant, TU
B10	∩	NM		Shallow reentrant, NM
B11	∩	FB		Reentrant, FB
B12	→	AK		E reentrant, AK
B13	∩	2.5m IL	⌋	Foot of earth bank, 2.5m high and IL
B14	∩	SB	<	Bend in stream, SB
F01	↓	WI		S reentrant, WI
F02	■	FL	∩	S side of building, FL (water)
F03	∩	SD	<	Bend in stream, SD
F04	∩	3m EC	⌋	Foot of cliff, 3m high and EC
F05	∩	SW		Reentrant, SW
F06	↓	NY		S reentrant, NY
F07	∩	ND		Shallow reentrant, ND
F08	←	OR		W shallow reentrant, OR
F09	■	VT	○	NW side of building, VT (manned)
F10	→	KM		E reentrant, KM
F11	∩	5m NC	⌋	Foot of cliff, 5m high and NC
F12	∩	4m UT	⌋	Foot of cliff, 4m high and UT
F13	∩	3m WV	⌋	Foot of cliff, 3m high and WV
F14	→	MN		E shallow reentrant, MN
F15	→	5m MT	⌋	Foot of E cliff, 5m high and MT
F16	∩	IN		Stream, IN
F17	∩	PQ	∩	NW foot of spur, PQ (water)
F18	∩	TX	<	Bend in stream, TX
F19	∩	10m GH	⌋	Foot of cliff, 10m high and GH
F20	∩	PN		SW reentrant, PN
W01	∩	DB		Reentrant, DB
W02	∩	ID		Reentrant, ID
W03	⊗	TN	∩	S side of root stock, TN
W04	∩	PR	+	Reentrant, PR (first aid)
W05	∩	UM		Shallow saddle, UM
W06	∩	GA	∩	Reentrant, GA (water)